

Massachusetts Cultural Resource Information System

Scanned Record Cover Page

Inventory No:	SWN.75
Historic Name:	Rebekah, Dorothy Brown Lodge
Common Name:	Ledgeview Children's Center
Address:	98 Ledge Rd
City/Town:	Swansea
Village/Neighborhood:	Gardner's Neck;
Local No:	47;
Year Constructed:	1899
Architectural Style(s):	Shingle Style;
Use(s):	Community Center; Other Educational; Other Recreational; Other Social;
Significance:	Architecture; Community Planning; Recreation; Social History;
Area(s):	SWN.D
Designation(s):	Nat'l Register District (02/16/1990); Nat'l Register MRA (02/16/1990);
Building Materials:	Roof: Asphalt Shingle; Wall: Wood Shingle; Foundation: Concrete Unspecified;
Demolished	No



The Massachusetts Historical Commission (MHC) has converted this paper record to digital format as part of ongoing projects to scan records of the Inventory of Historic Assets of the Commonwealth and National Register of Historic Places nominations for Massachusetts. Efforts are ongoing and not all inventory or National Register records related to this resource may be available in digital format at this time.

The MACRIS database and scanned files are highly dynamic; new information is added daily and both database records and related scanned files may be updated as new information is incorporated into MHC files. Users should note that there may be a considerable lag time between the receipt of new or updated records by MHC and the appearance of related information in MACRIS. Users should also note that not all source materials for the MACRIS database are made available as scanned images. Users may consult the records, files and maps available in MHC's public research area at its offices at the State Archives Building, 220 Morrissey Boulevard, Boston, open M-F, 9-5.

Users of this digital material acknowledge that they have read and understood the MACRIS Information and Disclaimer (<http://mhc-macris.net/macrisdisclaimer.htm>)

Data available via the MACRIS web interface, and associated scanned files are for information purposes only. THE ACT OF CHECKING THIS DATABASE AND ASSOCIATED SCANNED FILES DOES NOT SUBSTITUTE FOR COMPLIANCE WITH APPLICABLE LOCAL, STATE OR FEDERAL LAWS AND REGULATIONS. IF YOU ARE REPRESENTING A DEVELOPER AND/OR A PROPOSED PROJECT THAT WILL REQUIRE A PERMIT, LICENSE OR FUNDING FROM ANY STATE OR FEDERAL AGENCY YOU MUST SUBMIT A PROJECT NOTIFICATION FORM TO MHC FOR MHC'S REVIEW AND COMMENT. You can obtain a copy of a PNF through the MHC web site (www.sec.state.ma.us/mhc) under the subject heading "MHC Forms."

Commonwealth of Massachusetts
Massachusetts Historical Commission
220 Morrissey Boulevard, Boston, Massachusetts 02125
www.sec.state.ma.us/mhc

This file was accessed on: Monday, June 27, 2022 at 7:54 PM

A-6ARD
USGS - FALL

NRMPA
NADIS > 2/10/90

AREA

FORM NO.

D.E 75

1C

Town SWANSEA

Address 98 Ledge Road

Historic Name Dorothy Brown Rebekah Lodge

Use: Present Daycare Center

Original Community Center

DESCRIPTION

Date 1899

Source Records of Dorothy Brown Rebekah Lodge #122, I.O.O.F.

Style Late "shingle style"

Architect Unknown

Exterior Wall Fabric weathered shingle

Outbuildings None

Major Alterations (with dates) NO

Condition _____

Moved NO Date _____

Acreage Less than one acre

Setting _____

Recorded by Kim Valente/H. Pierce '78

Organization Swansea Historical Commission

Date March, 1986



Location
ings

Intersection(s).
Indicate north

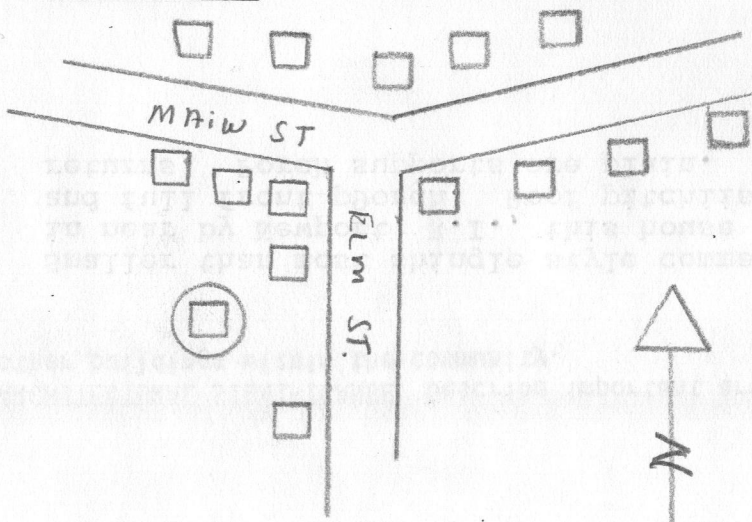

UTM REFERENCE _____

USGS QUADRANGLE Fall River, MA., R.I., 1967

SCALE _____

NATIONAL REGISTER CRITERIA STATEMENT (if applicable)

ARCHITECTURAL SIGNIFICANCE Describe important architectural features and evaluate in terms of other buildings within the community.

Smaller than most shingle style commercial buildings, typically of those in near by Newport, R.I., this house offers three open bays on its facade and full front porch. Roof pitch is high and gable ends have large returns. Porch supports are plain.

HISTORICAL SIGNIFICANCE Explain the role owners played in local or state history and how the building relates to the development of the community.

Although this two story hall and meeting place was erected for the use of the Dorothy Brown Rebekah Lodge, it was used for many years as a community center for varied activities. Public clamakes were served to as many as a thousand people in the surrounding grove. Community groups and church organizations scheduled meetings and public suppers there. In the summer lawn parties with outdoor dancing took place on the lighted grounds. Groups from other towns often hired the hall and grounds for picnics.

Since 1970 Ledgeview Children's Service Center has operated a day care center for young children there. The situation is ideal for such an undertaking.

The lodge is named for Dorothy Brown wife of John Brown one of the founders of the town of Swansea. Several of her descendants have been members.

BIBLIOGRAPHY and/or REFERENCES

Fall River Registry of Deeds, Book 56, pg. 315
 Book 979, pg. 13
 Records of the Dorothy Brown Rebekah Lodge #122, I.O.O.F.
History of Swansea, O.O. Wright, 1917.

FORM B - BUILDING

MASSACHUSETTS HISTORICAL COMMISSION
Office of the Secretary, State House, Boston

In Area no.

C.

Form no.

47 75

2.



4. Map. Draw sketch of building location in relation to nearest cross streets and other buildings. Indicate north.

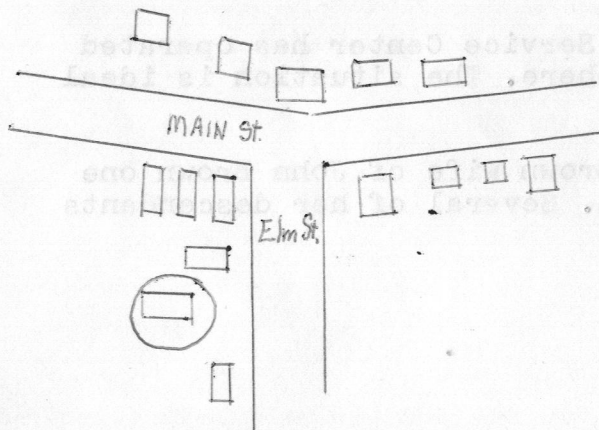

RECEIVED

MAR 28 1979

MASS. HIST. COMM.

1. Town Swansea, Massachusetts

Address 98 Ledge Road

Name Ledgeview Children's Center

Present use Daycare Center

Present owner Storca, Inc.

3. Description:

Date 1899

Records of Dorothy Brown
Source Rebekah Lodge #122, I.O.O.F.

Style "Shingle Style"

Architect Unknown - Elmer D. Young
Builder

Exterior wall fabric Weathered shingle

Outbuildings (describe) None

Other features

Altered No Date

Moved No Date

5. Lot size:

One acre or less X Over one acre

Approximate frontage 123 feet

Approximate distance of building from street

25 feet

6. Recorded by Helen Pierce

Organization Swansea Historical Soc.

Date August 3, 1978

(over)

7. Original owner (if known) Dorothy Brown Rebekah Lodge #122, I.O.O.F.

Original use Lodge Meetings and Social Activities

Subsequent uses (if any) and dates Day Care Center since 1970

8. Themes (check as many as applicable)

Aboriginal	<u> </u>	Conservation	<u> </u>	Recreation	<u> X </u>
Agricultural	<u> </u>	Education	<u> X </u>	Religion	<u> </u>
Architectural	<u> </u>	Exploration/ settlement	<u> </u>	Science/ invention	<u> </u>
The Arts	<u> </u>	Industry	<u> </u>	Social/ humanitarian	<u> X </u>
Commerce	<u> </u>	Military	<u> </u>	Transportation	<u> </u>
Communication	<u> </u>	Political	<u> </u>		
Community development	<u> X </u>				

9. Historical significance (include explanation of themes checked above)

Although this two story hall and meeting place was erected for the use of the Dorothy Brown Rebekah Lodge it was used for many years as a community center for varied activities. Public clambakes were served to as many as a thousand people in the surrounding grove. Community groups and church organizations scheduled meetings and public suppers there. In the summer lawn parties with outdoor dancing took place on the lighted grounds. Groups from other towns often hired the hall and grounds for picnics.

Since 1970 Ledgeview Children's Service Center has operated a day care center for young children there. The situation is ideal for such an undertaking.

The lodge is named for Dorothy Brown wife of John Brown one of the founders of the Town of Swansea. Several of her descendants have been members.

10. Bibliography and/or references (such as local histories, deeds, assessor's records, early maps, etc.)

Records of the Dorothy Brown Rebekah Lodge #122, I.O.O.F.

Fall River Registry of Deeds, Book 56, page 315.
Book 979, page 13.

History of Swansea, O.O.Wright, 1917.