

Massachusetts Cultural Resource Information System

Scanned Record Cover Page

Inventory No:	SWN.72
Historic Name:	Swansea Union Manufacturing Company
Common Name:	Swan Finishing Company
Address:	11 Ledge Rd End of Ledge Rd
City/Town:	Swansea
Village/Neighborhood:	Gardner's Neck;
Local No:	48;
Year Constructed:	C 1889
Architectural Style(s):	Colonial Revival; No style;
Use(s):	Bleachery; Business Office; Dye House; Grist Mill; Industrial Complex or District; Paper Mill; Printing Shop; Textile Mill Cotton; Warehouse;
Significance:	Architecture; Industry;
Area(s):	SWN.D
Designation(s):	Nat'l Register District (02/16/1990); Nat'l Register MRA (02/16/1990);
Building Materials:	Wall: Brick;
Demolished	Yes



The Massachusetts Historical Commission (MHC) has converted this paper record to digital format as part of ongoing projects to scan records of the Inventory of Historic Assets of the Commonwealth and National Register of Historic Places nominations for Massachusetts. Efforts are ongoing and not all inventory or National Register records related to this resource may be available in digital format at this time.

The MACRIS database and scanned files are highly dynamic; new information is added daily and both database records and related scanned files may be updated as new information is incorporated into MHC files. Users should note that there may be a considerable lag time between the receipt of new or updated records by MHC and the appearance of related information in MACRIS. Users should also note that not all source materials for the MACRIS database are made available as scanned images. Users may consult the records, files and maps available in MHC's public research area at its offices at the State Archives Building, 220 Morrissey Boulevard, Boston, open M-F, 9-5.

Users of this digital material acknowledge that they have read and understood the MACRIS Information and Disclaimer (<http://mhc-macris.net/macrisdisclaimer.htm>)

Data available via the MACRIS web interface, and associated scanned files are for information purposes only. THE ACT OF CHECKING THIS DATABASE AND ASSOCIATED SCANNED FILES DOES NOT SUBSTITUTE FOR COMPLIANCE WITH APPLICABLE LOCAL, STATE OR FEDERAL LAWS AND REGULATIONS. IF YOU ARE REPRESENTING A DEVELOPER AND/OR A PROPOSED PROJECT THAT WILL REQUIRE A PERMIT, LICENSE OR FUNDING FROM ANY STATE OR FEDERAL AGENCY YOU MUST SUBMIT A PROJECT NOTIFICATION FORM TO MHC FOR MHC'S REVIEW AND COMMENT. You can obtain a copy of a PNF through the MHC web site (www.sec.state.ma.us/mhc) under the subject heading "MHC Forms."

Commonwealth of Massachusetts
Massachusetts Historical Commission
220 Morrissey Boulevard, Boston, Massachusetts 02125
www.sec.state.ma.us/mhc

This file was accessed on: Monday, June 27, 2022 at 7:54 PM



intersection(s).
Indicate north

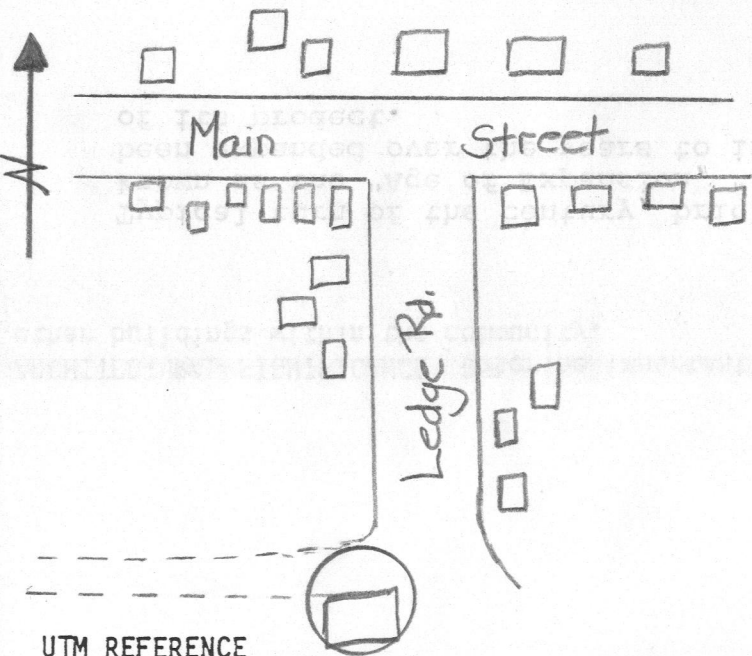

UTM REFERENCE

USGS QUADRANGLE Fall River, MA-RI 1967-79

SCALE

PL-67ED
USGS-RAU
NPRWA
NRDIS > 2/16/90
AREA
FORM NO.
DE 72
2C
1 NC

Town SWANSEA

Address End of Ledge Road

Historic Name SWAN FINISHING WAREHOUSE

Use: Present Swan Finishing Warehouse

Original Industrial

DESCRIPTION

Date c. 1850 1889

Source Records of Swansea Print Works

Style

Architect

Exterior Wall Fabric brick

Outbuildings various sheds

Major Alterations (with dates) Several

Additions dates unknown

Condition

Moved No Date

Acreage Over one acre

Setting Located at the end of the street

facing what is known as Interstate 6

Recorded by K. Valente/ H. Pierce '78

Organization Swansea Historical Commission

Date March, 1986

NATIONAL REGISTER CRITERIA STATEMENT (if applicable)

ARCHITECTURAL SIGNIFICANCE Describe important architectural features and evaluate in terms of other buildings within the community.

Typical turn of the century, brick, factory, built at the end of what was known as the "Age of Expansion, " and before the "Age of Industry." Has been expanded over the years to include larger working space and handling of its product.

HISTORICAL SIGNIFICANCE Explain the role owners played in local or state history and how the building relates to the development of the community.

The year 1813 is the first indebtifiable date for a mill at this site. No doubt there was on earlier. The grist mill was followed by a cotton mill, then a paper mill. Next came a Bleachery, next a dye works and then a flourishing pront works. This company was sold in 1956 and the Swan Finishing Company purchased the plant in 1958. The pond, the damn and the mill were one holding until 1958. Now the water rights are owned by the Montaup Electric Company.

BIBLIOGRAPHY and/or REFERENCES

- Records and photographs of Swansea Print Works.
- History of Swansea, O.O. Wright.
- Scrabbletown, Alice Brayton, 1943

FORM B - BUILDING

MASSACHUSETTS HISTORICAL COMMISSION
Office of the Secretary, State House, Boston

In Area no.

C.

Form no.

4872



in relation to nearest cross streets and other buildings. Indicate north.

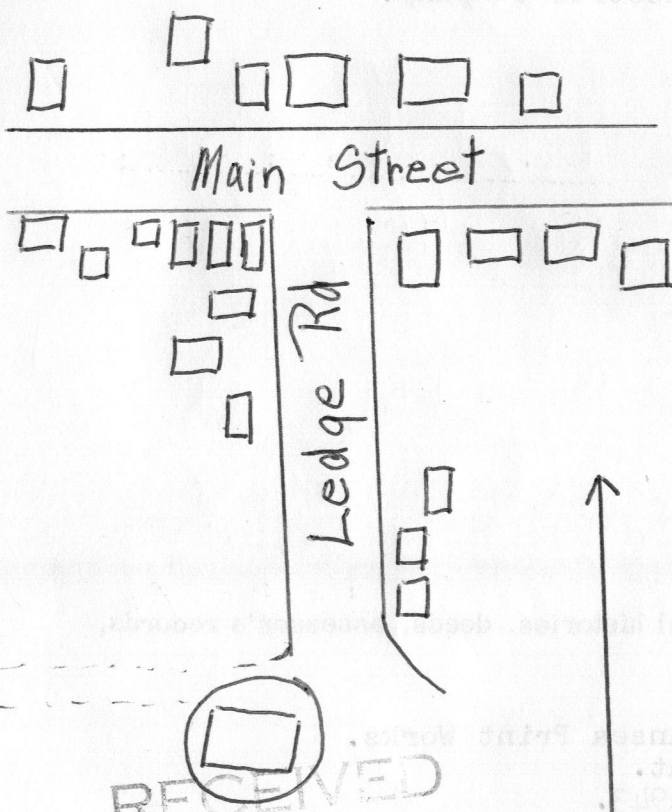

RECEIVED

MAR 28 1979

MASS. HIST. COMM.

1. Town Swansea, Massachusetts

Address End of Ledge Road

Name Swan Finishing Co.

Present use Warehouse

Present owner Swan Finishing Co.

3. Description:

Date 1889 ?

Source Records of Swansea Print Works

Style _____

Architect _____

Exterior wall fabric Brick

Outbuildings (describe) Various sheds

Other features _____

Altered Several additions Date _____

Moved No Date _____

5. Lot size:

One acre or less _____ Over one acre X

Approximate frontage 300 feet

Approximate distance of building from street

50 feet to gate

6. Recorded by Helen Pierce

Organization Swansea Historical Soc.

Date October 9, 1978

(over)

7. Original owner (if known) Caleb Easterbrook

Original use Industrial

Subsequent uses (if any) and dates _____

8. Themes (check as many as applicable)

Aboriginal	_____	Conservation	_____	Recreation	_____
Agricultural	_____	Education	_____	Religion	_____
Architectural	_____	Exploration/	_____	Science/	_____
The Arts	_____	settlement	_____	invention	_____
Commerce	_____	Industry	<u>X</u>	Social/	_____
Communication	_____	Military	_____	humanitarian	_____
Community development	<u>X</u>	Political	_____	Transportation	<u>X</u>

9. Historical significance (include explanation of themes checked above)

1813 is the first identifiable date for a mill at this site. No doubt there was one earlier. The grist mill was followed by a cotton mill, then a paper mill. Next came a Bleachery, next a dye works and then a flourishing print works. The name Swansea Print Works came to be used in 1926. This company was sold in 1956 and the Swan Finishing Company purchased the plant in 1958. The pond, the dam and the mill were one holding until 1958. Now the water rights are owned by the Montaup Electric Company.

10. Bibliography and/or references (such as local histories, deeds, assessor's records, early maps, etc.)

Records and photographs of Swansea Print Works.
History of Swansea, O.O. Wright.
Scrabbletown, Alice Brayton, 1943.