

Massachusetts Cultural Resource Information System

Scanned Record Cover Page

Inventory No:	SWN.136
Historic Name:	
Common Name:	
Address:	Shawmut Ave
City/Town:	Swansea
Village/Neighborhood:	South Swansea; Gardner's Neck;
Local No:	
Year Constructed:	C 1930
Architectural Style(s):	Colonial Revival;
Use(s):	Secondary Dwelling House;
Significance:	Architecture; Recreation;
Area(s):	SWN.H
Designation(s):	
Building Materials:	Roof: Asphalt Shingle; Wall: Wood Shingle;
Demolished	No



The Massachusetts Historical Commission (MHC) has converted this paper record to digital format as part of ongoing projects to scan records of the Inventory of Historic Assets of the Commonwealth and National Register of Historic Places nominations for Massachusetts. Efforts are ongoing and not all inventory or National Register records related to this resource may be available in digital format at this time.

The MACRIS database and scanned files are highly dynamic; new information is added daily and both database records and related scanned files may be updated as new information is incorporated into MHC files. Users should note that there may be a considerable lag time between the receipt of new or updated records by MHC and the appearance of related information in MACRIS. Users should also note that not all source materials for the MACRIS database are made available as scanned images. Users may consult the records, files and maps available in MHC's public research area at its offices at the State Archives Building, 220 Morrissey Boulevard, Boston, open M-F, 9-5.

Users of this digital material acknowledge that they have read and understood the MACRIS Information and Disclaimer (<http://mhc-macris.net/macrisdisclaimer.htm>)

Data available via the MACRIS web interface, and associated scanned files are for information purposes only. THE ACT OF CHECKING THIS DATABASE AND ASSOCIATED SCANNED FILES DOES NOT SUBSTITUTE FOR COMPLIANCE WITH APPLICABLE LOCAL, STATE OR FEDERAL LAWS AND REGULATIONS. IF YOU ARE REPRESENTING A DEVELOPER AND/OR A PROPOSED PROJECT THAT WILL REQUIRE A PERMIT, LICENSE OR FUNDING FROM ANY STATE OR FEDERAL AGENCY YOU MUST SUBMIT A PROJECT NOTIFICATION FORM TO MHC FOR MHC'S REVIEW AND COMMENT. You can obtain a copy of a PNF through the MHC web site (www.sec.state.ma.us/mhc) under the subject heading "MHC Forms."

Commonwealth of Massachusetts
Massachusetts Historical Commission
220 Morrissey Boulevard, Boston, Massachusetts 02125
www.sec.state.ma.us/mhc

This file was accessed on: Monday, June 27, 2022 at 8:05 PM

USGS - FALL
R2 - S. SWAN
GARD

AREA	FORM NO.
<u>F</u>	<u>136</u>

H

Town SWANSEA

Address Shawmut Avenue

Historic Name _____

Use: Present Summer Cottage

Original Summer Cottage

DESCRIPTION

Date ca. 1930

Source Visual analysis

Style Colonial revival shingle

Architect _____

Exterior Wall Fabric Shingle

Outbuildings 2-car detached garage

Major Alterations (with dates) _____

Unknown

Condition Fair - in unstable state of preservation with repairs due

Moved No Date _____

Acreage More than one acre

Setting Located directly on the Lee River across from Brayton Pt. and the N.E. Power Co. in a remaining summer colony area.

Recorded by Kay Flynn/Kim Valente

Organization Swansea Historical Commission

Date May, 1986

between inventoried property and nearest intersection(s).
Indicate north

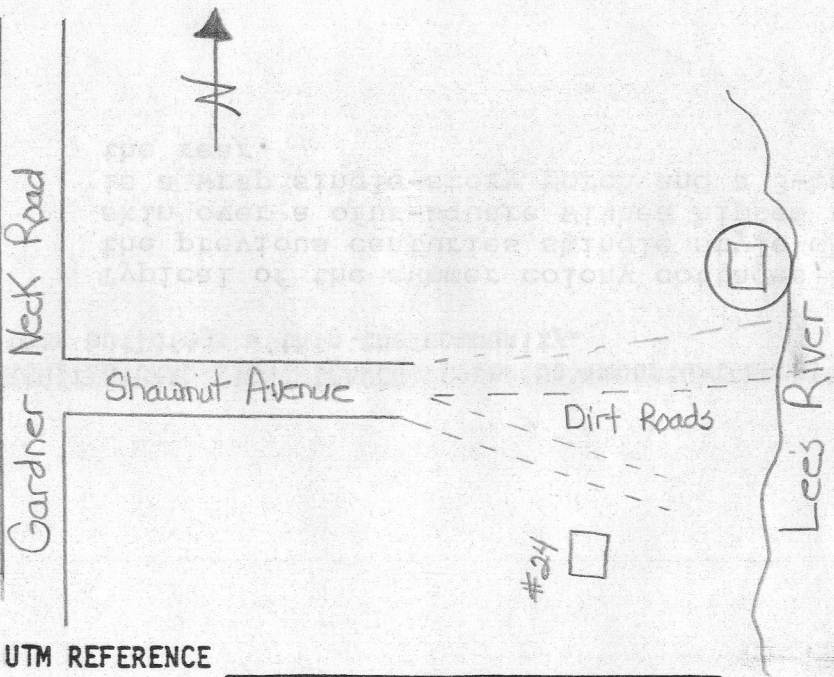

UTM REFERENCE _____

USGS QUADRANGLE Fall River, Ma., R.I. 1967/79

SCALE _____

NATIONAL REGISTER CRITERIA STATEMENT (if applicable)**ARCHITECTURAL SIGNIFICANCE** Describe important architectural features and evaluate in terms of other buildings within the community.

Typical of the summer colony cottages, this Colonial Revival has many of the previous centuries shingle style characteristics. It has a shingle skin over a ofur-square with a hipped roof on a two-story house. There is a wrap single-story porch and a 3-bay, 1-story ell with chimney off the rear.

HISTORICAL SIGNIFICANCE Explain the role owners played in local or state history and how the building relates to the development of the community.

The significance lies in the section of Gardners Neck in which this house is located. It was one of the first areas in town to be inhabited by natives and Colonists alike and in the early 20th century became the area of Swansea for substantial summer cottages. This is one of the few remaining "summer only" cottages. Most all the other homes are now year round.

BIBLIOGRAPHY and/or REFERENCES

Maps

Interview with Mr. O'Neill 6/4/86 who stated "the Kennedys live in this neighboring house and were only there in the summer."