

Massachusetts Cultural Resource Information System

Scanned Record Cover Page

Inventory No:	SWN.124
Historic Name:	Saint Michael's School
Common Name:	
Address:	Pinehurst Ave Pinehurst & Anthony Aves
City/Town:	Swansea
Village/Neighborhood:	Ocean Grove; Gardner's Neck;
Local No:	
Year Constructed:	1931
Architectural Style(s):	Colonial Revival;
Use(s):	Abandoned or Vacant; Private School;
Significance:	Architecture; Education; Religion;
Area(s):	SWN.G
Designation(s):	
Building Materials:	Roof: Asphalt Shingle; Wall: Brick;
Demolished	No



The Massachusetts Historical Commission (MHC) has converted this paper record to digital format as part of ongoing projects to scan records of the Inventory of Historic Assets of the Commonwealth and National Register of Historic Places nominations for Massachusetts. Efforts are ongoing and not all inventory or National Register records related to this resource may be available in digital format at this time.

The MACRIS database and scanned files are highly dynamic; new information is added daily and both database records and related scanned files may be updated as new information is incorporated into MHC files. Users should note that there may be a considerable lag time between the receipt of new or updated records by MHC and the appearance of related information in MACRIS. Users should also note that not all source materials for the MACRIS database are made available as scanned images. Users may consult the records, files and maps available in MHC's public research area at its offices at the State Archives Building, 220 Morrissey Boulevard, Boston, open M-F, 9-5.

Users of this digital material acknowledge that they have read and understood the MACRIS Information and Disclaimer (<http://mhc-macris.net/macrisdisclaimer.htm>)

Data available via the MACRIS web interface, and associated scanned files are for information purposes only. THE ACT OF CHECKING THIS DATABASE AND ASSOCIATED SCANNED FILES DOES NOT SUBSTITUTE FOR COMPLIANCE WITH APPLICABLE LOCAL, STATE OR FEDERAL LAWS AND REGULATIONS. IF YOU ARE REPRESENTING A DEVELOPER AND/OR A PROPOSED PROJECT THAT WILL REQUIRE A PERMIT, LICENSE OR FUNDING FROM ANY STATE OR FEDERAL AGENCY YOU MUST SUBMIT A PROJECT NOTIFICATION FORM TO MHC FOR MHC'S REVIEW AND COMMENT. You can obtain a copy of a PNF through the MHC web site (www.sec.state.ma.us/mhc) under the subject heading "MHC Forms."

Commonwealth of Massachusetts
Massachusetts Historical Commission
220 Morrissey Boulevard, Boston, Massachusetts 02125
www.sec.state.ma.us/mhc

This file was accessed on: Monday, June 27, 2022 at 8:04 PM

FORM B - BUILDING

MASSACHUSETTS HISTORICAL COMMISSION
80 BOYLSTON STREET
BOSTON, MA 02116



Sketch Map: Draw map showing property's location in relation to nearest cross streets and/or geographical features. Indicate all buildings between inventoried property and nearest intersection(s).
Indicate north

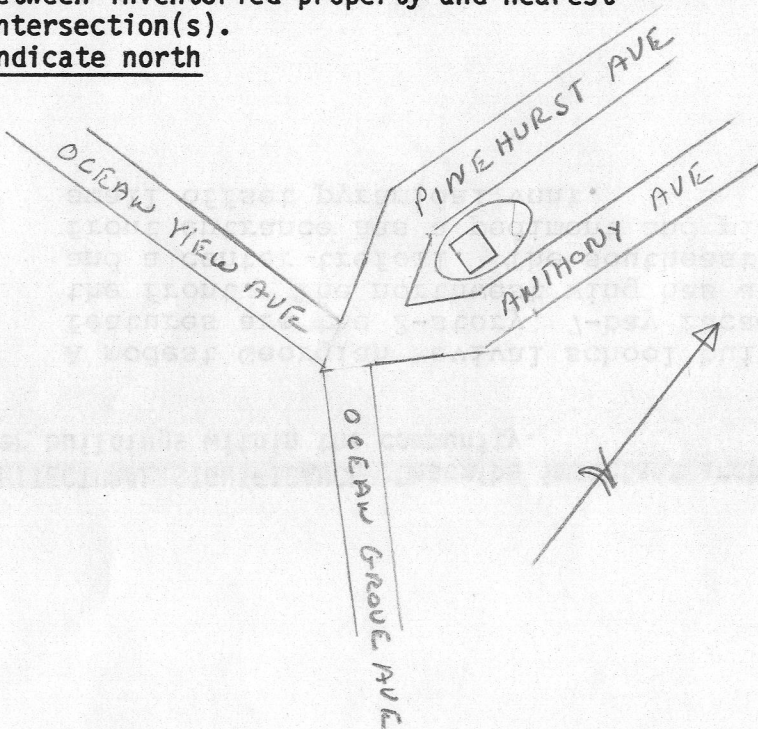

UTM REFERENCE _____

USGS QUADRANGLE Fall River, MA., R.I. 1967/79

SCALE _____

PL - Ocean
GARD
USGS - FALL
AREA E FORM NO. 124

SWANSEA

Address Pinehurst and Anthony Avenues

Historic Name St. Michael's School

Present Vacant

Original School

DESCRIPTION

Year 1931

Occasion Tercentenary

Style Georgian Revival

Architect _____

Exterior Wall Fabric Brick

Outbuildings _____

Major Alterations (with dates) _____

Unknown

Condition Good even though it has been vacant since 1970's.

Moved No Date _____

Acreage Approximately 1 acre

Setting Located at the intersection of Pinehurst and Anthony in the northeast section of Ocean Grove, a mixed small lot, residential/commercial area.

Recorded by Kay Flynn

Organization Swansea Historical Commission

Date May, 1986

NATIONAL REGISTER CRITERIA STATEMENT (if applicable)

ARCHITECTURAL SIGNIFICANCE Describe important architectural features and evaluate in terms of other buildings within the community.

A modest Georgian Revival school built in the 1930's. The characteristic features are the 2-story, 7-bay facade with flanking wings, gable ends to the front. The northwest wing has an all brick facade with patterned brick and a center trefoil. The southeast wing has 3 windows on each floor. The front entrance has a pediment and pilasters. There is no cupola but a small offset pyramidal vent.

HISTORICAL SIGNIFICANCE Explain the role owners played in local or state history and how the building relates to the development of the community.

The demand for parochial schools was brought about by the tremendous growth of Swansea during the 1920's and , in particular by the steady increase in population in the summer then year-round area of Ocean Grove. St. Michael's School was conducted by the Sisters of St Joseph and the Diocesan School Superintendent and was organized in 1931. In 1967 there was an enrollment of 338 students in Kindergarten through grade 8. The school was closed in the early 1980's.

BIBLIOGRAPHY and/or REFERENCES

Swansea Tercentenary, pg. 54