

Massachusetts Cultural Resource Information System

Scanned Record Cover Page

Inventory No:	SWN.127
Historic Name:	Saint Michael the Archangel Church
Common Name:	
Address:	270 Ocean Grove Ave
City/Town:	Swansea
Village/Neighborhood:	Ocean Grove; Gardner's Neck;
Local No:	16;
Year Constructed:	1922
Architectural Style(s):	Not researched;
Use(s):	Church; Church Hall;
Significance:	Architecture; Recreation; Religion;
Area(s):	SWN.G
Designation(s):	
Building Materials:	Roof: Asphalt Shingle; Wall: Brick; Concrete Unspecified; Wood; Foundation: Concrete Unspecified;
Demolished	No



The Massachusetts Historical Commission (MHC) has converted this paper record to digital format as part of ongoing projects to scan records of the Inventory of Historic Assets of the Commonwealth and National Register of Historic Places nominations for Massachusetts. Efforts are ongoing and not all inventory or National Register records related to this resource may be available in digital format at this time.

The MACRIS database and scanned files are highly dynamic; new information is added daily and both database records and related scanned files may be updated as new information is incorporated into MHC files. Users should note that there may be a considerable lag time between the receipt of new or updated records by MHC and the appearance of related information in MACRIS. Users should also note that not all source materials for the MACRIS database are made available as scanned images. Users may consult the records, files and maps available in MHC's public research area at its offices at the State Archives Building, 220 Morrissey Boulevard, Boston, open M-F, 9-5.

Users of this digital material acknowledge that they have read and understood the MACRIS Information and Disclaimer (<http://mhc-macris.net/macrisdisclaimer.htm>)

Data available via the MACRIS web interface, and associated scanned files are for information purposes only. THE ACT OF CHECKING THIS DATABASE AND ASSOCIATED SCANNED FILES DOES NOT SUBSTITUTE FOR COMPLIANCE WITH APPLICABLE LOCAL, STATE OR FEDERAL LAWS AND REGULATIONS. IF YOU ARE REPRESENTING A DEVELOPER AND/OR A PROPOSED PROJECT THAT WILL REQUIRE A PERMIT, LICENSE OR FUNDING FROM ANY STATE OR FEDERAL AGENCY YOU MUST SUBMIT A PROJECT NOTIFICATION FORM TO MHC FOR MHC'S REVIEW AND COMMENT. You can obtain a copy of a PNF through the MHC web site (www.sec.state.ma.us/mhc) under the subject heading "MHC Forms."

Commonwealth of Massachusetts
Massachusetts Historical Commission
220 Morrissey Boulevard, Boston, Massachusetts 02125
www.sec.state.ma.us/mhc

This file was accessed on: Monday, June 27, 2022 at 8:01 PM

FORM B - BUILDING

MASSACHUSETTS HISTORICAL COMMISSION
80 BOYLSTON STREET
BOSTON, MA 02116

AREA E FORM NO. 127



own SWANSEA - Ocean Grove

Address 270 Ocean Grove Avenue

Historic Name Saint Michael the Archangel Church

Present Church

Original Church

DESCRIPTION

Date May 22, 1922

Source Church Records; Assessors' Map 49 - Lot 250

Style Moderne

Architect Supervised by Alfred Freatette

Exterior Wall Fabric Red Brick

Outbuildings Rectory - garage

Major Alterations (with dates) Church

raised to allow basement to be used as a meeting place. (May 1963)

Condition Good - well maintained

Moved No Date

Acreage Less than one acre

Setting Situated on the corner of what is the "commercial center" of Ocean Grove. The structure is not setback from the street and therefore no landscaping.

Recorded by Kay Flynn/C.L. Gardner May 1978

Organization Swansea Historical Commission

Date January 1986

Sketch Map: Draw map showing property's location in relation to nearest cross streets and/or geographical features. Indicate all buildings between inventoried property and nearest intersection(s). Indicate north

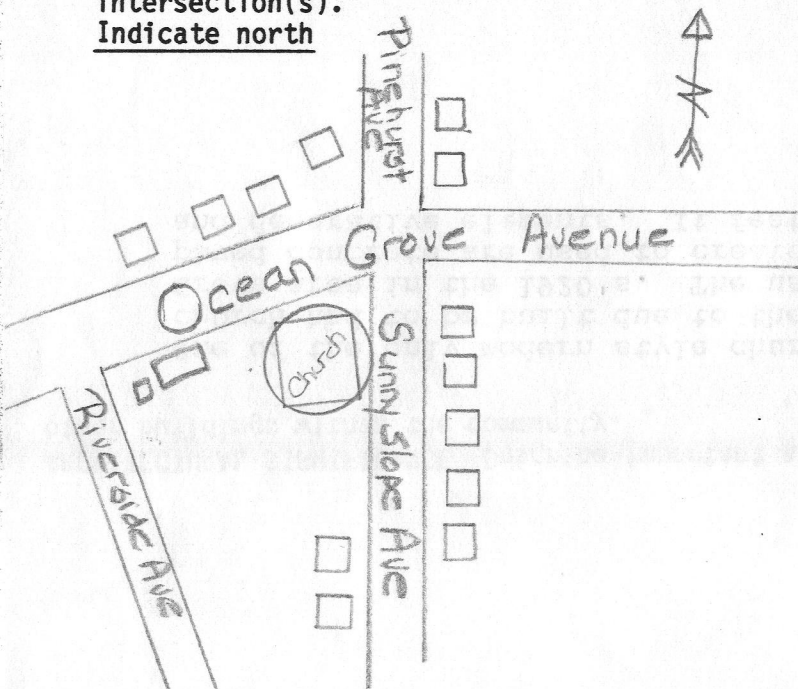

UTM REFERENCE

USGS QUADRANGLE

SCALE

NATIONAL REGISTER CRITERIA STATEMENT (if applicable)

ARCHITECTURAL SIGNIFICANCE Describe important architectural features and evaluate in terms of other buildings within the community.

One of the only modern style churches in Swansea, this modest type church had to be built due to the increasing population of the Ocean Grove area in the 1920's. The use of brick, plastered and painted paved concrete are used to create the smooth surfaces and simple angle and decorative elements. It features a spire on a square bell tower.

HISTORICAL SIGNIFICANCE Explain the role owners played in local or state history and how the building relates to the development of the community.

Bishop Daniel Feehan, Ordinary of the Fall River Diocese, felt there was a need for a new parish in the Ocean Grove area of Swansea. The task of founding the new parish was assigned to the Rev. Osias Boucher. At the time Ocean Grove was a resort area with summer homes and only a few year-round homes. Many people came from Fall River, Ma., Warren, R.I. and Pawtucket, R.I. to the resort area. They had to travel back to their home for Sunday Mass, and most travelled by electric cars. As a result, a number of the residents started a campaign to raise money for a church knowing that a church was to be built. A number of the residents decided to winterize their homes. Records show that the parishioners were the carpenters, plumbers, masons, etc. supervised by Alfred Freanette. It was enlarged in 1963 because of additional families staying year-round in Ocean Grove.

BIBLIOGRAPHY and/or REFERENCES

The 50th Anniversary Book (researched by parishioners)
Town Hall Assessors' Records
Church Records

FORM B - BUILDING

MASSACHUSETTS HISTORICAL COMMISSION
Office of the Secretary, State House, Boston

In Area no.

Form no.

16
127



1. Town Swansea, Mass.

Address Ocean Grove Avenue

Name St. Michael the Archangel Church

Present use Church

Present owner Incumbent Bishop of the Diocese of Fall River, Mass.

3. Description:

Date May 22, 1922

Source Church Records; Assessors' Map 49 - Lot 250

Style Built by skilled artisan parish-ioners, supervised by Alfred Freanette.

Exterior wall fabric Red Brick

Outbuildings (describe) Rectory - garage

Other features _____

Church raised to allow basement
Altered to be used as a meeting place. Date May 2, 1963 -
Moved _____ Date _____ completed

5. Lot size:

One acre or less less Over one acre _____

Approximate frontage 163.12 feet

Approximate distance of building from street
10 feet

6. Recorded by Calvin L. Gardner

Organization Swansea Historical Society

Date May 24, 1978

4. Map. Draw sketch of building location in relation to nearest cross streets and other buildings. Indicate north.

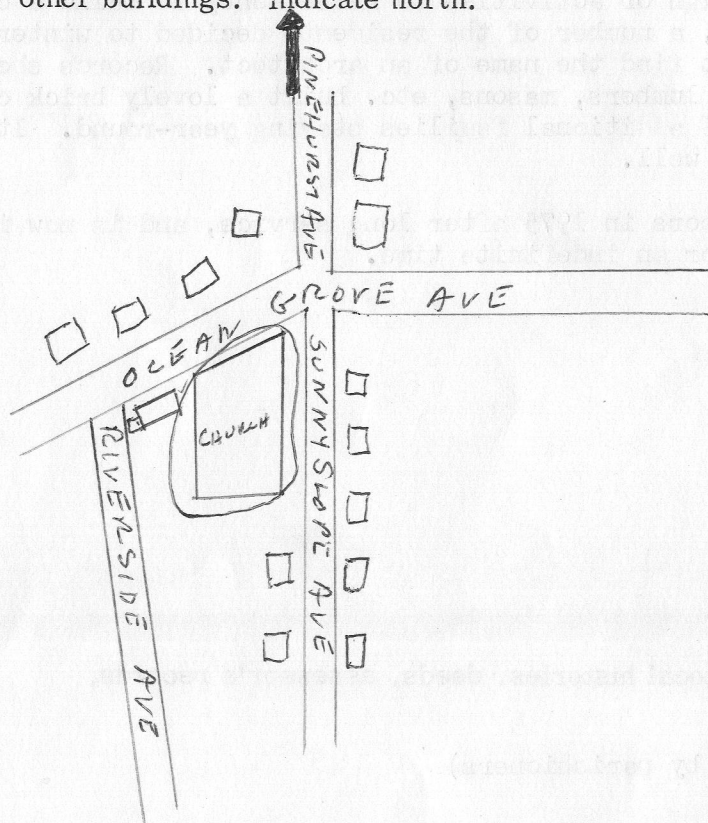

RECEIVED

JUN 13 1978

(over)

MASS. HIST. COMM.

7. Original owner (if known) Incumbent Bishop of the Diocese of Fall River

Original use Church

Subsequent uses (if any) and dates _____

8. Themes (check as many as applicable)

Aboriginal	_____	Conservation	_____	Recreation	_____
Agricultural	_____	Education	_____	Religion	<u>X</u>
Architectural	<u>✓</u>	Exploration/ settlement	_____	Science/ invention	_____
The Arts	_____	Industry	_____	Social/ humanitarian	_____
Commerce	_____	Military	_____	Transportation	_____
Communication	_____	Political	_____		
Community development	_____				

9. Historical significance (include explanation of themes checked above) Bishop Daniel Feehan, Ordinary of the Fall River Diocese, felt there was a need for a new parish in the Ocean Grove area of Swansea. The task of founding the new parish was assigned to the Rev. Osias Boucher. At the time Ocean Grove was a lovely resort area studded with summer homes and only a few year-round homes. Many people came from Fall River, Mass., Warren, R. I. and Pawtucket, R. I. They had to travel back home for Sunday Mass, and to get to most churches they had to travel by electric cars. As a result, a number of the residents set a campaign of activities to raise money to build a church. Knowing that a church was to be built, a number of the residents decided to winterize their homes and stayed here. I do not find the name of an architect. Records show that the people who were carpenters, plumbers, masons, etc. built a lovely brick church. It had to be enlarged later because of additional families staying year-round. It serves its parishioners and community well.

The St. Michael's school closed its doors in 1975 after long service, and is now in use by the Public Schools of Swansea for an indefinite time.

10. Bibliography and/or references (such as local histories, deeds, assessor's records, early maps, etc.)

the 50th Anniversary Book (researched by parishioners)
Town Hall Assessors' records
Church records.