

# Massachusetts Cultural Resource Information System

## Scanned Record Cover Page

<b>Inventory No:</b>	SWN.139
<b>Historic Name:</b>	Watters, Harden C. House
<b>Common Name:</b>	
<b>Address:</b>	936 Gardner's Neck Rd
<b>City/Town:</b>	Swansea
<b>Village/Neighborhood:</b>	South Swansea; Gardner's Neck;
<b>Local No:</b>	13;
<b>Year Constructed:</b>	1898
<b>Architectural Style(s):</b>	Shingle Style;
<b>Use(s):</b>	Secondary Dwelling House; Single Family Dwelling House;
<b>Significance:</b>	Architecture; Recreation;
<b>Area(s):</b>	SWN.H
<b>Designation(s):</b>	
<b>Building Materials:</b>	Roof: Asphalt Shingle; Wall: Wood Shingle; Foundation: Cobblestone;
<b>Demolished</b>	No



The Massachusetts Historical Commission (MHC) has converted this paper record to digital format as part of ongoing projects to scan records of the Inventory of Historic Assets of the Commonwealth and National Register of Historic Places nominations for Massachusetts. Efforts are ongoing and not all inventory or National Register records related to this resource may be available in digital format at this time.

The MACRIS database and scanned files are highly dynamic; new information is added daily and both database records and related scanned files may be updated as new information is incorporated into MHC files. Users should note that there may be a considerable lag time between the receipt of new or updated records by MHC and the appearance of related information in MACRIS. Users should also note that not all source materials for the MACRIS database are made available as scanned images. Users may consult the records, files and maps available in MHC's public research area at its offices at the State Archives Building, 220 Morrissey Boulevard, Boston, open M-F, 9-5.

Users of this digital material acknowledge that they have read and understood the MACRIS Information and Disclaimer (<http://mhc-macris.net/macrisdisclaimer.htm>)

Data available via the MACRIS web interface, and associated scanned files are for information purposes only. THE ACT OF CHECKING THIS DATABASE AND ASSOCIATED SCANNED FILES DOES NOT SUBSTITUTE FOR COMPLIANCE WITH APPLICABLE LOCAL, STATE OR FEDERAL LAWS AND REGULATIONS. IF YOU ARE REPRESENTING A DEVELOPER AND/OR A PROPOSED PROJECT THAT WILL REQUIRE A PERMIT, LICENSE OR FUNDING FROM ANY STATE OR FEDERAL AGENCY YOU MUST SUBMIT A PROJECT NOTIFICATION FORM TO MHC FOR MHC'S REVIEW AND COMMENT. You can obtain a copy of a PNF through the MHC web site ([www.sec.state.ma.us/mhc](http://www.sec.state.ma.us/mhc)) under the subject heading "MHC Forms."

Commonwealth of Massachusetts  
Massachusetts Historical Commission  
220 Morrissey Boulevard, Boston, Massachusetts 02125  
[www.sec.state.ma.us/mhc](http://www.sec.state.ma.us/mhc)

This file was accessed on: Monday, June 27, 2022 at 7:37 PM

PL - S. SWAN  
GARD  
USGS - FALL

AREA

FORM NO.

<del>F</del>	139
--------------	-----

H

Town SWANSEA

Address 936 Gardner's Neck Road

Historic Name Harden C. Watters

Use: Present Year-round Residence

Original Summer Residence

### DESCRIPTION

Date 1898

Source Assessors' Records, Swansea

Style Map - 50 - Lot - 150  
Shingle

Architect \_\_\_\_\_

Exterior Wall Fabric wood shingles

Outbuildings Two car garage (later)

Major Alterations (with dates) None

Condition Fair; new roof detracts from  
continuity of shingle style

Moved No Date \_\_\_\_\_

Acreage Over one Acre

Setting \_\_\_\_\_

Recorded by Kay Flynn/C.L. Gardner  
May 1978

Organization Swansea Historical  
Commission

Date January 1986



Location  
ings

between inventoried property and nearest  
intersection(s).  
Indicate north

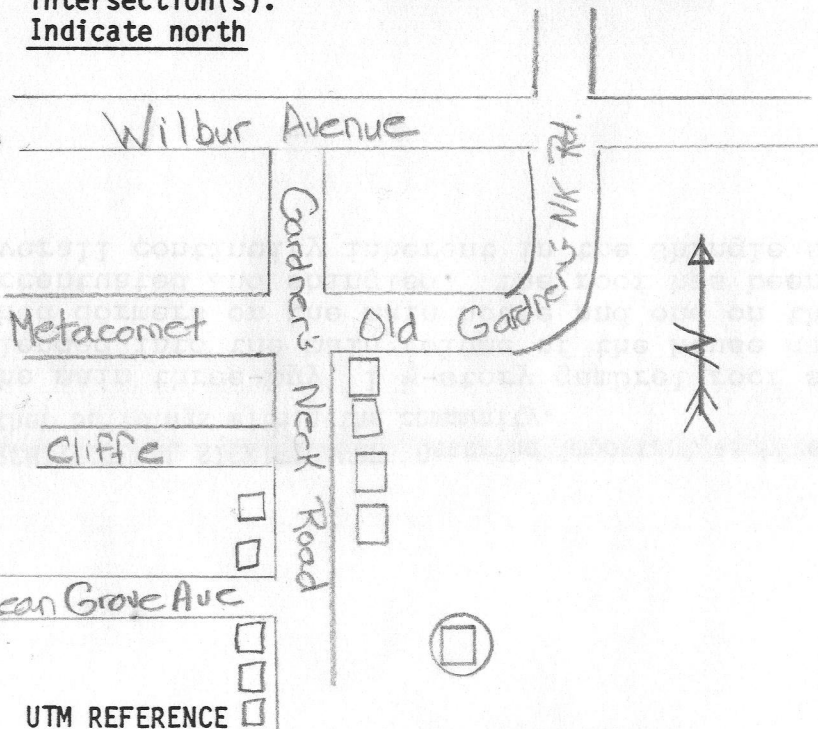

UTM REFERENCE \_\_\_\_\_

USGS QUADRANGLE Fall River, Mass. R1 1967-79

SCALE \_\_\_\_\_

## NATIONAL REGISTER CRITERIA STATEMENT (if applicable)

**ARCHITECTURAL SIGNIFICANCE** Describe important architectural features and evaluate in terms of other buildings within the community.

The main three-bay, 1 ½-story gambrel roof structure with a one story porch blended into the main volume of the house has a setback ell. It features two shed dormers on the main house and one on the ell. The piers of the porch are accentuated and shingled. The roof has been re-shingled and detracts from the overall continuity inherent in the Shingle style.

**HISTORICAL SIGNIFICANCE** Explain the role owners played in local or state history and how the building relates to the development of the community.

This house is an example of the more modest shingle style summer residences before 1900. The Consolidated Railroad operated a train between Providence and Fall River with a stop at South Swansea, which made this area accessible to summer residence in 1898. Harden C. Watters lived in Providence, R.I. and bought ten acres of land from Elizabeth, the widow of Henry Gardner, Jr., who was a descendant of the first Samuel Gardner who settled on Gardner's Neck.

## BIBLIOGRAPHY and/or REFERENCES

Assessors' Records, Swansea



FORM B - BUILDING

MASSACHUSETTS HISTORICAL COMMISSION  
Office of the Secretary, State House, Boston

In Area no.

Form no.

139

2.



1. Town Swansea, Mass.

Address 936 Gardner's Neck Road

Name \_\_\_\_\_

Present use Residence

Present owner Pauline E. Freeman

3. Description:

Date 1898

Source Assessors' Records, Swansea

Map 50 - Lot 150

Style Shingle

Architect \_\_\_\_\_

Exterior wall fabric Wood Shingles

Outbuildings (describe) Garage

Other features Porch- Dormer Windows

Altered No Date \_\_\_\_\_

Moved No Date \_\_\_\_\_

5. Lot size:

One acre or less \_\_\_\_\_ Over one acre 1.4 A

Approximate frontage 125 feet

Approximate distance of building from street

120 feet

6. Recorded by Calvin L. Gardner

Organization Swansea Historical Society

Date May 24, 1978

4. Map. Draw sketch of building location in relation to nearest cross streets and other buildings. Indicate north.



RECEIVED

JUN 13 1978

(over)

MASS. HIST. COMM.

7. Original owner (if known) Harden C. Watters

Original use Summer residence

Subsequent uses (if any) and dates Year-round residence

8. Themes (check as many as applicable)

Aboriginal	<u>          </u>	Conservation	<u>          </u>	Recreation	<u>          </u>
Agricultural	<u>          </u>	Education	<u>          </u>	Religion	<u>          </u>
Architectural	<u>  x  </u>	Exploration/ settlement	<u>          </u>	Science/ invention	<u>          </u>
The Arts	<u>          </u>	Industry	<u>          </u>	Social/ humanitarian	<u>          </u>
Commerce	<u>          </u>	Military	<u>          </u>	Transportation	<u>          </u>
Communication	<u>          </u>	Political	<u>          </u>		
Community development	<u>  x  </u>				

9. Historical significance (include explanation of themes checked above)

(Summer Colony in South Swansea - railroad)

This house is a good example of the shingle style of architecture in vogue before 1900. The exterior has not been changed since it was built.

Mr. Watters lived in Providence, R. I. He bought ten acres of land from Elizabeth, the widow of Henry Gardner, Jr., a descendant of the first Samuel Gardner who settled on Gardner's Neck. The Consolidated Railroad operated a train between Providence and Fall River with a stop at South Swansea, which made this area accessible to summer visitors. Mr. Watters built his summer residence in 1898.

10. Bibliography and/or references (such as local histories, deeds, assessor's records, early maps, etc.)

Assessors' Records, Swansea