

# Massachusetts Cultural Resource Information System

## Scanned Record Cover Page

<b>Inventory No:</b>	SWN.115
<b>Historic Name:</b>	Davis House
<b>Common Name:</b>	
<b>Address:</b>	141 Wilbur Ave
<b>City/Town:</b>	Swansea
<b>Village/Neighborhood:</b>	Touisset;
<b>Local No:</b>	17;
<b>Year Constructed:</b>	1894
<b>Architectural Style(s):</b>	Victorian Eclectic;
<b>Use(s):</b>	Library; Single Family Dwelling House;
<b>Significance:</b>	Architecture; Community Planning;
<b>Area(s):</b>	
<b>Designation(s):</b>	
<b>Building Materials:</b>	Roof: Asphalt Shingle; Wall: Wood Clapboard; Wood Shingle; Foundation: Stone, Uncut;
<b>Demolished</b>	No



The Massachusetts Historical Commission (MHC) has converted this paper record to digital format as part of ongoing projects to scan records of the Inventory of Historic Assets of the Commonwealth and National Register of Historic Places nominations for Massachusetts. Efforts are ongoing and not all inventory or National Register records related to this resource may be available in digital format at this time.

The MACRIS database and scanned files are highly dynamic; new information is added daily and both database records and related scanned files may be updated as new information is incorporated into MHC files. Users should note that there may be a considerable lag time between the receipt of new or updated records by MHC and the appearance of related information in MACRIS. Users should also note that not all source materials for the MACRIS database are made available as scanned images. Users may consult the records, files and maps available in MHC's public research area at its offices at the State Archives Building, 220 Morrissey Boulevard, Boston, open M-F, 9-5.

Users of this digital material acknowledge that they have read and understood the MACRIS Information and Disclaimer (<http://mhc-macris.net/macrisdisclaimer.htm>)

Data available via the MACRIS web interface, and associated scanned files are for information purposes only. THE ACT OF CHECKING THIS DATABASE AND ASSOCIATED SCANNED FILES DOES NOT SUBSTITUTE FOR COMPLIANCE WITH APPLICABLE LOCAL, STATE OR FEDERAL LAWS AND REGULATIONS. IF YOU ARE REPRESENTING A DEVELOPER AND/OR A PROPOSED PROJECT THAT WILL REQUIRE A PERMIT, LICENSE OR FUNDING FROM ANY STATE OR FEDERAL AGENCY YOU MUST SUBMIT A PROJECT NOTIFICATION FORM TO MHC FOR MHC'S REVIEW AND COMMENT. You can obtain a copy of a PNF through the MHC web site ([www.sec.state.ma.us/mhc](http://www.sec.state.ma.us/mhc)) under the subject heading "MHC Forms."

Commonwealth of Massachusetts  
Massachusetts Historical Commission  
220 Morrissey Boulevard, Boston, Massachusetts 02125  
[www.sec.state.ma.us/mhc](http://www.sec.state.ma.us/mhc)

This file was accessed on: Monday, June 27, 2022 at 8:05 PM

FORM B - BUILDING

MASSACHUSETTS HISTORICAL COMMISSION  
80 BOYLSTON STREET

R-TDV  
USGS-KAL

AREA FORM NO.  
115



wn SWANSEA  
dress 141 Wilbur Avenue  
storic Name Davis House  
e: Present Redicence  
Original Residence  
SCRIPTION  
ce 1894  
rce Stone in foundation  
yle Queen Anne

Sketch Map: Draw map showing property's location in relation to nearest cross streets and/or geographical features. Indicate all buildings between inventoried property and nearest intersection(s). Indicate north

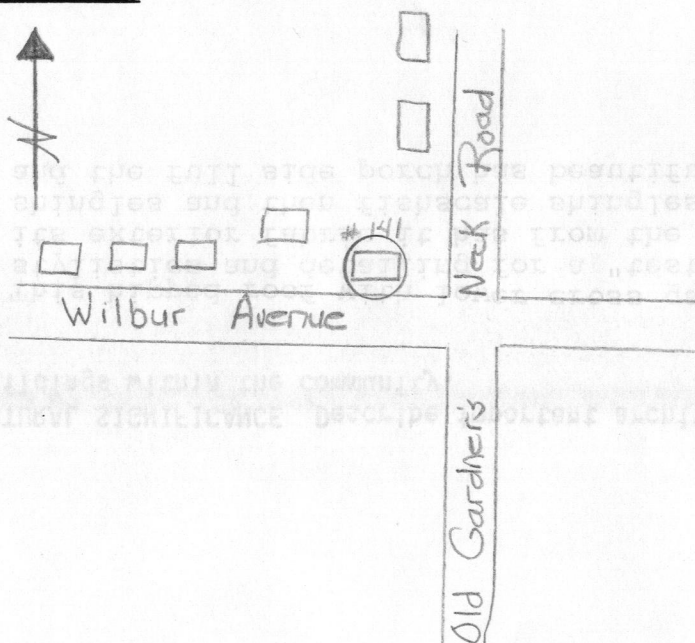

UTM REFERENCE  
USGS QUADRANGLE  
SCALE

Architect Unknown  
Exterior Wall Fabric Clapboard and shingle  
Outbuildings Large barn matching the house architectural lines and detail  
Major Alterations (with dates) None  
Condition  
Moved No Date  
Acreage Less than one acre  
Setting Sits on a major congested corner also known as Rt 103.  
Recorded by Kim Valente/H. Pierce '80  
Organization Swansea Historical Commission  
Date April, 1986

## NATIONAL REGISTER CRITERIA STATEMENT (if applicable)

**ARCHITECTURAL SIGNIFICANCE** Describe important architectural features and evaluate in terms of other buildings within the community.

This hipped roof with lower cross gable Queen Ann has all the authentic stylistics and detailing for a "test book" Queen Ann. Starting with its exterior fabric it has from the bottom up clapboards then coursed shingles and then fishscale shingles. The foundation is of fieldstone, and the full side porch has beautiful spindle work.

**HISTORICAL SIGNIFICANCE** Explain the role owners played in local or state history and how the building relates to the development of the community.

The intersection where the Davis house is situated was called Davis' Corner because the Davis family owned the land on three of the corners. Jonathan Davis, Sr. had eight children - six boys and two girls. Prior to 1897 he erected a building in the southwest corner where his son Leroy operated a grocery store and grain business. North of his home he built a two-family house for his sons, Charles and Jonathan, Jr. They operated the milk business started by their father for several years at the same location before moving to Fall River. Milk was purchased from local producers and marketed in the city.

The Davis Store changed names with succeeding owners but was primarily a food store. The store in the southern part of town, service was supplied to distant families with deliveries by horse and wagon into the early 1900's.

During the 1920's, the South Swansea Branch Library began operations on the east side of the building but the library later was moved to larger quarters.

## BIBLIOGRAPHY and/or REFERENCES

Fall River Registry of Deeds



FORM B - BUILDING

MASSACHUSETTS HISTORICAL COMMISSION  
Office of the Secretary, State House, Boston

In Area no.

Form no.

21 68 115



1. Town Swansea, Mass.

Address 141 Wilbur Avenue

Name Davis House

Present use Residential

Present owner James R. McKown

3. Description:

Date 1894

Source Cut stone in foundation

Style

Architect Unknown

Exterior wall fabric Clapboard & shingle

Outbuildings (describe) Large barn matching house in architectural lines.

Other features

Altered No

Date

Moved No

Date

5. Lot size:

One acre or less X Over one acre

Approximate frontage 187 feet

Approximate distance of building from street  
30 feet

Helen Pierce

6. Recorded by Martha S. Gendron

Ruth Doodson

Organization Swansea Historical Society

Date June 10, 1980

4. Map. Draw sketch of building location in relation to nearest cross streets and other buildings. Indicate north.

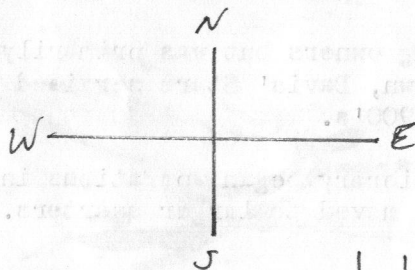

Barn

141

Wilbur Avenue

Gardner Neck Road

(over)

7. Original owner (if known) Jonathan Davis

Original use Residential

Subsequent uses (if any) and dates \_\_\_\_\_

8. Themes (check as many as applicable)

Aboriginal	_____	Conservation	_____	Recreation	_____
Agricultural	_____	Education	<u>X</u>	Religion	_____
Architectural	<u>X</u>	Exploration/ settlement	_____	Science/ invention	_____
The Arts	_____	Industry	<u>X</u>	Social/ humanitarian	_____
Commerce	_____	Military	_____	Transportation	_____
Communication	_____	Political	_____		
Community development	<u>X</u>				

9. Historical significance (include explanation of themes checked above)

The intersection where the Davis house is situated was called Davis' Corner because the Davis family owned the land on three of the corners. Jonathan Davis, Sr. had eight children - six boys and two girls. Prior to 1897 he erected a building on the southwest corner where his son Leroy operated a grocery store and grain business. North of his home he built a two-family house for his sons, Charles and Jonathan, Jr. They operated the milk business started by their father for several years at the same location before moving to Fall River. Milk was purchased from local producers and marketed in the city.

The Davis Store changed names with succeeding owners but was primarily a food store. The only store in the southern part of town, service was supplied to distant families with deliveries by horse and wagon into the early 1900's.

During the 1920's, the South Swansea Branch Library began operations on the east side of the building but the library later was moved to larger quarters.

10. Bibliography and/or references (such as local histories, deeds, assessor's records, early maps, etc.)

Fall River Registry of Deeds:

Book 21 - p.549 1894 366 sq. rds. Joseph G. Macomber to Jonathan Davis cor. Gardner's  
 Book 320 - p.525 April 17, 1923 Neck Rd. & Cole's River Rd.  
 Book " - p.527 and Book 336 - p. 9 - to Mary E. Holland  
 Book 343 - p. 115 June 19, 1925 - to Frank Champlin of East Longmeadow  
 Book 427 - p. 288 Dec. 31, 1937 - to Harriet & James Douthwright 99 sq. rds.



